



# FOR LEASE

107B - 2748 LOUGHEED HIGHWAY  
Port Coquitlam, BC

## WESTWOOD CENTRE OPPORTUNITY!!



Value Property Group  
(604) 606-7016  
info@valueindustries.com



SCAN ME

400 - 1245 W. Broadway  
Vancouver, BC V6H 1G7  
www.ValueGroupProperties.com

# For Lease

107B - 2748 LOUGHEED HIGHWAY  
PORT COQUITLAM, BC

## Location:

Located at the Southeast corner of Lougheed Highway and Westwood Street. High traffic from Port Coquitlam, Coquitlam & Port Moody.

Join BC Liquor Store, ReMax, Jenny Craig, DeDutch, Subway, Waves Coffee, Great Clips, Running Room and others at this highly active commercial centre in Port Coquitlam.



## The Centre:

- A high exposure, busy shopping centre
- Strategically located to service Port Coquitlam, Coquitlam & Port Moody
- Highly visible Pylon signage on both Westwood Street & on Lougheed Hwy.

## Zoning:

CC zoning (Community Commercial) allows for multiple uses, recreation and more.

## Unit Details:

- 2058 sq. ft. (approx.)
- Large, open space, back storage space & private washroom

## Lease Rate:

Please call for details.

## 2020 Taxes &

## Operating Costs:

\$15.58 per sq. ft.  
(excluding management fee)

## Availability:

December 1<sup>st</sup>, 2020

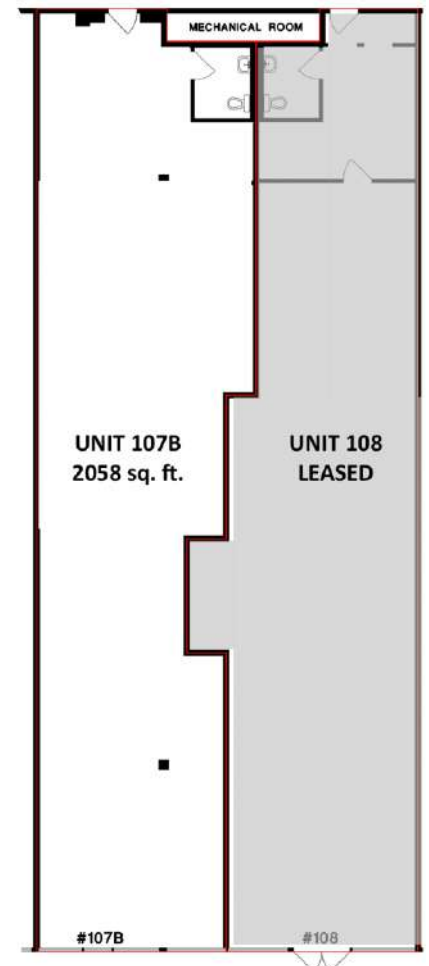

Note: The landlord has provided this information as a courtesy only and assumes no liability for its accuracy. All figures should be verified before relying on them. Rates subject to change.

Value Property Group  
(604) 606-7016  
info@valueindustries.com



SCAN ME

400 – 1245 W. Broadway  
Vancouver, BC V6H 1G7  
www.ValueGroupProperties.com